

Project Number 11045  
Purpose Subject Area Committee Meetings  
Location Bean East Conference Room  
Start Time 2:00 PM

## **CONFERENCE REPORT**    *Concert Hall*

### **01**    **THOSE PRESENT**

*Oregon Bach Festival*

John Evans, Michael Anderson

*University of Oregon, School of Music*

Brad Foley, Jennifer Craig, Tim Paul (Music and Dance)

*EMU*

Mary Barrios, Mike Kraiman, Ryan Rusby, Jessi Steward, Dana Winitzky

*EMU User Group*

Mandy Chong, Nora Alvarez, Dan Geiger, Kaitlyn Lange

*EMU Administration*

Wendy Polhemus, Mike Kraiman, Ryan Rusby, Jessi Steward, Dana Winitzky

*University of Oregon, Campus Planning and Real Estate*

Fred Tepfer

*University of Oregon, Capital Construction*

Darin Dehle

*The Shalleck Collaborative*

Adam Shalleck

*Kirkegaard*

Joseph Myers, Anthony Shou

*AC Martin*

Bob Murrin, Tammy Jow, Christopher King

*SERA Architects*

Natasha Koiv

### **02**    **DISCUSSION**

1. Adam Shalleck - Right-sizing the program
  - a. Concert Hall lobby has been right-sized from the B&D program (previously was at 1 sf/person; should be 6 sf/person): from 1,200 to 5,100 sf
2. SHARED LOBBY:

- a. For efficiency and cost reasons it was agreed that the Concert lobby should share with EMU 'hearth' or atrium space.
  - b. Bach Festival - always utilizes assigned seating, many university events are general seating.
  - c. It will require rechecking tickets after intermissions. It would be good to limit the number of entrances in order to control re-entry
  - d. Operationally, this is how ballroom operates now. Students as ushers check tickets.
  - e. The audience is mixed. This is Eugene. One person could be in a gown and the next person could be in shorts and sandals. We should not be talking in terms of two separate groups - "concert goers" and other people.
  - f. It is assumed that the lobby will be 'loud' and 'active', thus needs acoustical isolation from hall.
3. RESTROOMS were right-sized:
- a. For 600, provide 2x code
  - b. = 18 women; 41 sf/fixture
  - c. = 10 men; 38 sf/ fixture
4. CONCESSIONS
- a. Ohio State model of multi purpose base cabinets that could roll out and provide tabling, and push back into wall alcoves as counter space.
  - b. Portable bars/food concessions
  - c. CD sales
  - d. Power for portable locations to be considered
5. SHARED FUCTIONS:

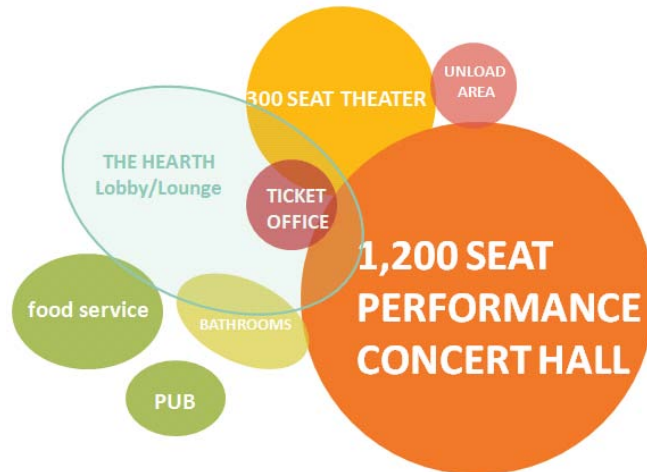

6. MULTI-PURPOSE ROOM/Rehearsal room
- a. 4,000 sf (60'X65') gives flexibility to be multi-purpose room as well as full rehearsal room
    - i. 4,000 sf can accommodate both chorus + orchestra up to 100 performers.
  - b. OBF prefers Mondavi model with double height room, and acoustically tuned for chorus and orchestra rehearsals. This could add costs
  - c. Floor area is appropriate for Dance floor - works for acoustics Variable acoustics, mechanical adjustments, isolation, etc. - after the double height walls - is a six digit dollar delta School of Music (dance) currently has facilities with pull out bleachers.
  - d. Dance could use it for more informal showings.

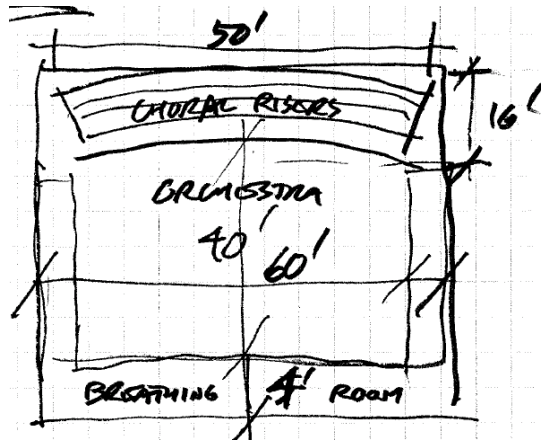

- e. Without theatrical component, dance will use current space.
  - f. Space could be for cinema/movies and general assembly with amplified sound capability.
  - g. Prefer flexibility that bleacher seating provides.
  - h. Alternate sizes: Could use 3000 SF and still function for rehearsal (60'X50')
7. Lay down Marley floor takes three hours to setup... Creates period where room cannot be used for other functions. Solution should look to floor surfaces that don't need a Marley floor.
  8. Minimum size for chorus + orchestra is 3,000 sf
  9. VIP LOUNGE
    - a. 500 sf
    - b. Could double as EMU Board Room or other conference room The Board will be nicely appointed During school year, scheduling conflict with Board Room student use.
  10. Oregon Bach Festival (OBF) operates June - July
  11. Ability to bring in higher tier performers because of lack of fly, setup manpower, multiuse coordination.
  12. Needs options for production. Projection functionality.
  13. Cyclorama - large white rear surface that receives a great deal of color light behind performers, front or rear projected, could be fabric Movable stage canopy that can be raised and lowered for varied uses
  14. Multiuse rigging adds \$200,000 in equipment. Add time for setup and tear down.
  15. Dance lighting is how we live
  16. STAFFING MODEL
    - a. Student crews
    - b. Currently do not have fly systems
    - c. Safety issue for student workers who have to lift things above their heads Can a student crew be used to fly things or does it have to be a professional crew?
    - d. Student labor can be used if supervised by a professional person

17. CONCERT HALL EXAMPLES

- a. University of Chicago - 550 seats, 55' tall, \$15-20 million, excellent for music and dance, 15' difference from stage to back row, pivoting panels at stage sides

18. Orchestra risers - no objections

- a. Stage is a flat solid object upon which platforms reside
- b. - time in labor or high first cost

19. Orchestra pit

- a. Allows for 30-40 musicians to be recessed from stage and audience elevations; recessing musicians allows focus to be on the singers on stage; pit is 8' below the stage and accessible from backstage.
- b. Conductor
- c. Is conducting the singers on stage and musicians in the pit see Joseph's diagram section of an orchestra pit, Pit has a lift: moves from pit level to stage level.
- d. Check elevator code regarding stage lift/pit accessibility.
- e. \$300,000 delta between pit lift - manual vs. automatic.

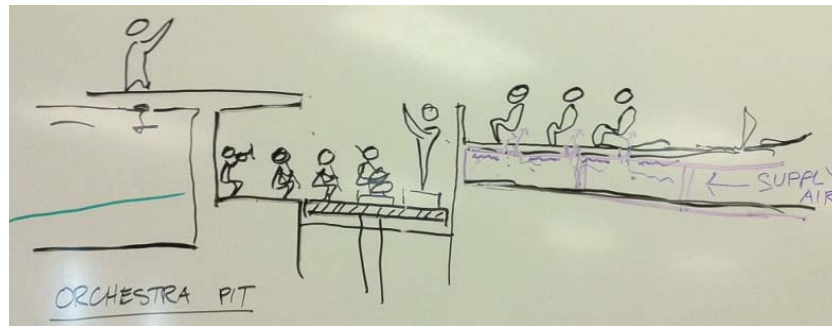

- 20. Stage elevation wants to be at ground floor level. Allows loading from street directly onto stage level.

21. Under floor air distribution

- a. Low supply approach is quieter, more economical to run, eliminates draft at the neck that would otherwise come from above, greener Add layer of absorption under floor, non combustible foam, to address possible vibration or noise from ducts Under floor air also at balcony seats, with gypsum board plenum.

22. No Organ

- 23. Martina suggests a survey to determine frequency of uses for various uses in the concert hall. Greg remembered that a summary of uses/needs was prepared previously, and should be redistributed to the group for review.

<b>Concert Hall-Patron Amenities</b>					Quantity	Unit	NASF	GSF	1.43
<b>See Shalleck Collaborative Program</b>									
Concert Hall Lobby	850	6	5,100	7,293					Shared
Includes Concessions Storage for Carts	1	150	150	215					Shared
Balcony Lobby	360	6	2,160	3,089					??
Box Office	0	150	0	0					Shared w/EMU Ticket Office
Stage Office	1	240	240	343					
Sound and Light Locks	4	75	300	429					
Woman's Restroom (2 levels)	0	800	0	0					Shared
Men's Restroom (2 levels)	0	400	0	0					Shared
VIP Lounge/Shared as EMU Board Room	0	500	0	0					Shared
Coat Room	1	100	100	143					
			<b>8,050</b>	<b>11,512</b>					

<b>Concert Hall-1200 Seats</b>					Quantity	Unit	NASF	GSF	1.82
Orchestra Seating	850	10	8,500	15,470					
Balcony Seating	300	10	3,000	5,460					
? Choir Balcony (not part of 1200 seat count)	60	10	600	1,092					alternate
Orchestra Pit	1	120	120	218					alternate
? Box Seating	50	20	1,000	1,820					
In-house Mix	1	100	100	182					
			<b>1262</b>	<b>13,320</b>				<b>24,242</b>	

<b>Concert Hall-Stage and Technical Areas</b>					NASF	GSF	1.67		
Performance Platform (stage)	1	2,700	2,700	4,509					
Crossover	1	2,250	2,250	3,758					
Dimmer Room	1	100	100	167					
Amplifier Room	1	100	100	167					
Control Suite	1	150	150	251				share common	
Recording Booth	1	300	300	501				room?	
? Crew Lockers Vending	1	60	60	100					
Backstage Restrooms	2	100	200	334					
Artist/conductor Green Room/Dressing?	1	200	200	334					
? Soloists-6/Dressing Room?	6	120	720	1,202				6 vs. 4	
Green Room/Dressing Room?	1	1,200	1,200	2,004					
Storage	1	1,500	1,500	2,505					
			<b>9,480</b>	<b>15,832</b>					

<b>TOTAL Performance Zone</b>			<b>30,850</b>	<b>51,586</b>					
-------------------------------	--	--	---------------	---------------	--	--	--	--	--

See also Joseph Meyer notes attached.

U. OREGON EMU #2714

18 Oct 11

MTG @ UO

BOB MURRIN  
TAMMY

PLUS MORES IN BACK ROWS

ANTHONY	KA
RYAN	
DANA	
JOHN	} OBF
MIKE	
BRAD	SOM
JENNIFER	DANCE
GREGG	
TIM	SOM
MIKE	
FRED	FACULTIES
DAN	
ADAM	THEATER CONS.
JOSEPH	KA

LOBBY

✓ BUT FRED WANTS LOBBY SHARED WITH EMU.

SIZED @ 6 SF/K, UP FROM 1 SF/K IN ORIGINAL PROGRAM.

SOM EVENTS ARE ALL PAID TICKETS - <sup>TYPICALLY</sup> GENERAL SEATING. STUDENTS SNEAK IN @ INTERMISSION, WHICH IS OK WITH BRAD.

ASSUMES THAT LOBBY IS LOUD & ACTIVE THROUGHOUT PERFORMANCE - MUST BE ACOUSTICALLY ISOLATED.

OBF IS ASSIGNED SEATING - DON'T WANT PEOPLE SNEAKING IN AT INTERMISSION.

RYAN - EMU BALLROOM (4 ENTRANCES @ GYM) - THEY ARE ACCUSTOMED TO MULTIPLE CHECKPOINTS

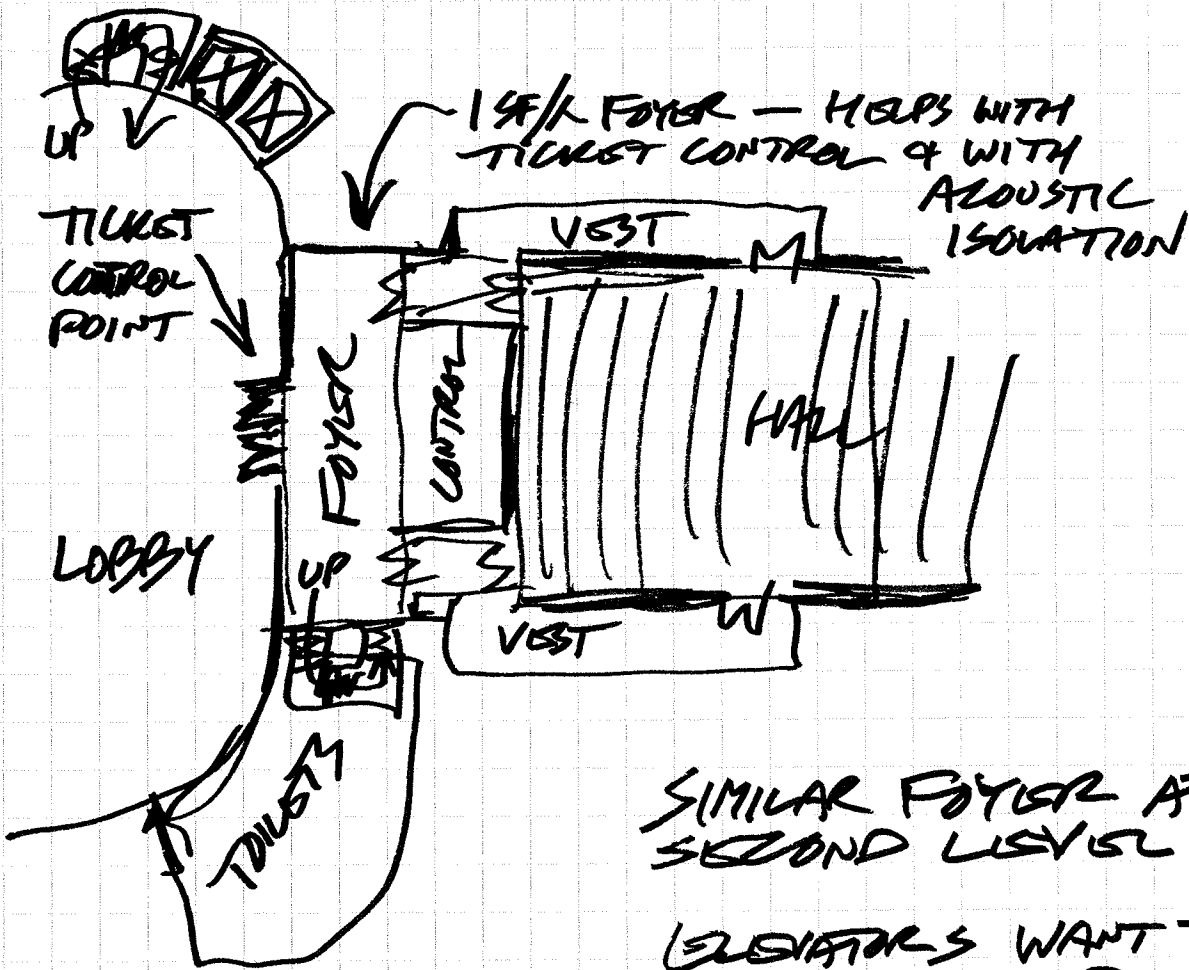

SIMILAR FOYER AT SECOND LEVEL.

ELEVATORS WANT TO BE SHARED WITH BUILDING -

CONSIDER INTERNAL STAIRS CONNECTING FOYERS - LEGAL FOR ADA?

### FOOD SERVICE IN LOBBY

PORTABLE BAR? ANY PROBLEM WITH STUDENTS AND CONCERT GOERS MINGLING? NO, IT'S FINE, JOHN - OBF AUDIENCES ARE NATURALLY MIXED.  
PUB IN LOBBY? GREGG IS CONSIDERING IT.

AVOID FIXED FURNITURE THAT GETS IN THE WAY.  
JENNIFER - DANCE AUDIENCES ARE 75% STUDENT.

COFFEE CARTS IN LOBBY + HIGHER END BAR AT ?  
DONOR LOUNGE.  
OBF CONCESSIONS:  
CD SALES - FRONT & CENTER } THEY ARE USED TO AND  
DRINKS / SNACKS } APPARENTLY LIKE THREE  
MERCHANDISE } DIFFERENT LOCATIONS

OHIO STATE  
ROOM HAS MOVABLE TABLES THAT LOCK TO WALLS  
4 MOVES AWAY FROM WALL WHEN SOMEONE NEEDS  
TO SIT BEHIND THEM - "TABLING" IS  
FREQUENT.

POWER & INTERNET NEEDS TO BE CLOSE BY THE  
TABLES.

COULD RELY ENTIRELY ON MOVABLE TABLES,  
OR COULD HAVE A FIXED MULTI-FUNCTION COUNTER,  
TO BE USED AS NEEDED, w/TABLES AS SUPPLEMENTS

↓ COULD BE AS LITTLE AS 3000 SF &  
STILL WORK FOR RM. UPTO 100

REH RM - 4000 SF - CAN FIT FULL ORCH WITH  
FULL CHAIRS (UPTO 100)

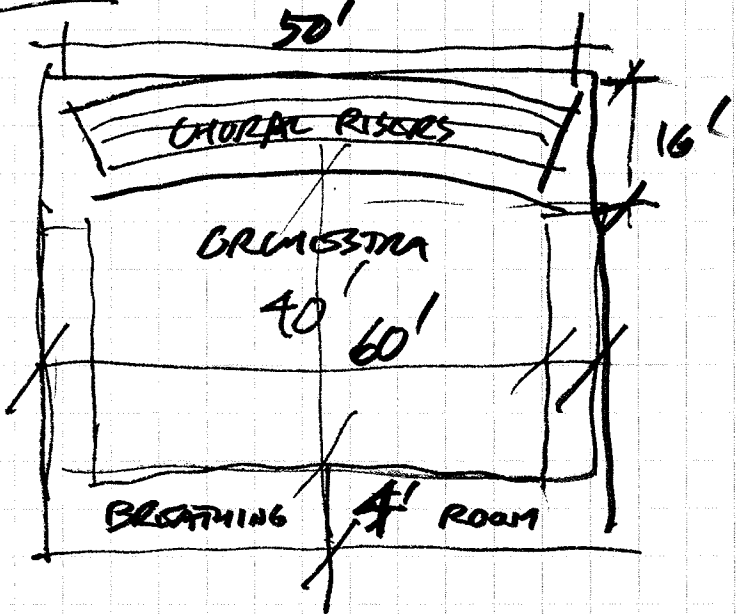

VS 2600 SF  
@ RM 190 -  
REH RM IN  
MUSIC BLDG -  
WHICH WORKS FOR THEM  
60' x 65'  
FOR 4000 SF  
60' x 50'  
FOR 3000 SF

FLOOR APPROPRIATE FOR DANCE - AMPLIFIED MUSIC,  
"WHATEVER CAN FIT IN THERE"  
USERS - DOESN'T NEED TO BE FIT OUT AS A THEATER.  
ADAM - NO NEED FOR IT TO BE BLACK.

ONLY  
AS A DANCE SPACE, WOULD WORK FOR LESS FORMAL  
PRESENTATIONS, UNLESS IT HAD WINGS & THEATRICAL LTO.

OWN SPACE (IN DANCE BLDG) IS PROBLEMATIC AND  
HEAVILY BOOKED. REH RM @ EMU WOULD BE  
NEEDING MORE FOR REHEARSAL, BLOCKING -  
IS THAT PRACTICAL GIVEN THE NEED FOR A MARSH?  
LOOK AT <sup>FLOOR</sup> FINISHES THAT DON'T NEED A MARSH.



ADAM -

COULD R504 RM BE VIP RM?

NO - NOT INTIMATE ENOUGH

COULD EMU BOARD RM BE VIP RM?

POSSIBLE - IF CONFERENCE FURNITURE CAN GO INTO STORAGE.

VIP RM/BOARD RM

COULD NATURALLY GO AT SECOND FLOOR/BALCONY LEVEL - DONOR HAS INTEREST IN VESTIBULE/COAT ROOMS BEHIND

"BOXES" THAT WOULD MAKE THEM FEEL MORE SPECIAL. TO HOST 50K - 500SE

DOUBLE WITH 800SE BOARD RM? SIZE WOULD BE FINE..

BOARD RM OFF LINE WED NIGHTS FOR SENATE (?) MTGS - WOULD NOT BE DURING JUNE/JULY WHEN OBF USE IS HEAVIEST - COULD OTHERWISE COORDINATE SCHEDULES.

GR66 - A HANDSOME 800SE RM WOULD BE HEAVILY BOOKED FOR A VARIETY OF FUNCTIONS.

## CONCERT HALL

IN CURRENT REHEARSAL/PERFORMANCE SPACE.

DANCE - NEEDS TO "BUILD THE THEATER" EVERY TIME  
- LAMES DRESSING ROOMS ITS USED - CONFLICTS WITH CLASSES.  
- NOTHING FLIES

SELL OUT 220K  
SMALL THEATER (500K) RESULT ALSO SELLS OUT. NO CROSSOVER

WANTS EXPANDED OPPORTUNITIES:

- GUEST ARTISTS NOT CURRENTLY ACCOMMODATED
- BIGGER AUDIENCES.

2 FORMAL CONCERTS / QUARTER WOULD LIKE TO DO MORE, BOTH FORMAL AND INFORMAL.

IN RSH RM/THEATER SET UP TIME IS  
BIG ISSUE - CONFLICTS W/CLASS USE. CONTROL  
BOOTH NOT ON CENTER LINE.

CONCERT HALL, TO ACCOMMODATE DANCE:  
CAT WALKS WOULD BE VALUABLE.

REAR PROJECTION?

CYL WOULD BE HIGHLY VALUABLE.

\*NEED SIDE LIGHTING\*

KESSIE - WOULD LIKE ABILITY TO FLY OVER STAGE  
FOR EMU RENTAL USES.

JENIFER - ROBINSON THEATER AVAILABLE EVERY  
OTHER YEAR FOR DANCE PERFORMANCES.

ADAM - "A FEW" MOTORIZED LINE SETS - \$200,000  
IN ADDITION TO MOVABLE CANOPY - FULL DAY  
LOAD IN & LOAD OUT.

MIKE - IMPACT ON LOADING DOCK?

ADAM - PROBABLY WOULD NOT BE ABLE TO  
JUSTIFY A 50' SEMI LOADING BAY.

JENIFER - LTB & COSTUMES ARE MAJOR ELEMENTS  
FOR TOURING DANCE - DOES NOT NEED BIG TRUCK

RYAN - EMU. BALLROOMS STAFFED BY STUDENT CREWS -  
TO BE SAFE, NEED ADULT SUPERVISION.

ADAM - STUDENTS FROM THEATER DEPT COULD  
CONTRIBUTE THEIR EXPERTISE.

RYAN - LOTS OF STUDENTS W/SOME SUPERVISION IS A  
SUCCESSFUL MODEL AT THEATER BLDG.

+ 39' x 56' DANCE PLAYING AREA AT PRESENT  
FOR DANCE - + 15' FURNINGS - WELL SIZED.

RISERS - OBF WANTS THEM - SOME WILLING  
TO HAVE THEM BUT DOESN'T.  
CURRENTLY USE THEM VERY OFTEN.

MOVABLE CANOPY

HIGHER FOR LARGE ENSEMBLES & CHORUS

JOHN - HIS FAVORITE HALLS HAVE FIXED CEILINGS, NOT CANOPIES.

6

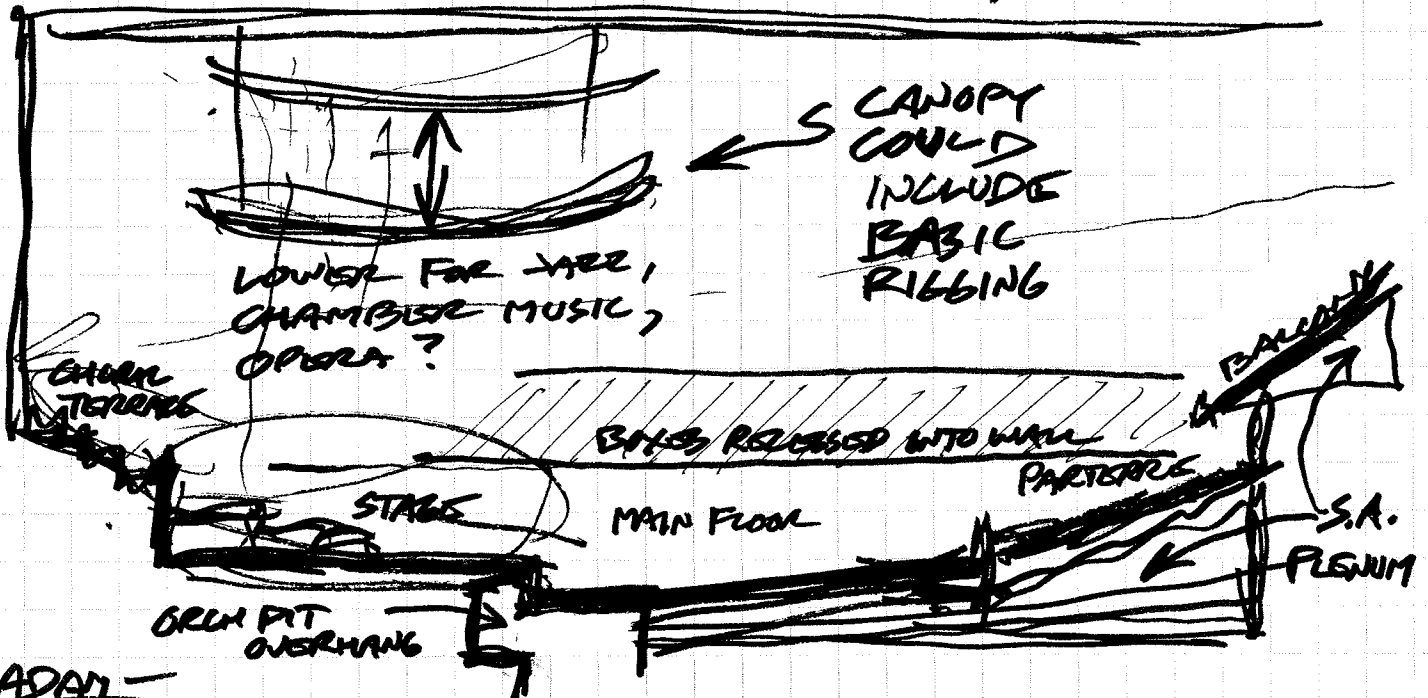

ADAM - BASIC LEGS & BORDERS COULD FRAME A DANCE PROSCENIUM.

JENNIFER - THAT WOULD BE WELCOME  
ANTHONY

GREEN HAS RIGGING STRIP FOR AD HOC CHAIN HOISTS OVER STAGE.

ADAM - LEAST INITIAL COST - HIGHEST OPERATIONAL COST.

JOHN - OPERA PIT IS NECESSARY - 30-40K

JENNIFER - WANT COLLABORATION w/ MUSIC & DANCE.

LARGE ORCH + LARGE CHORUS

